

Lifetime 2-inch Air-Cooled LED Light Source

(Product ID: LM2X-DMHP-XXX)

The lifetime 2-inch, air-cooled LED light source provides uniform, stable illumination, for pressure and temperature sensitive paint measurements. The LED is designed for lifetime acquisition systems. The system is overdriven, giving it a higher peak power per pulse than the continuous LED system. Pulse width and frequency are set by sending an external TTL signal to the BNC trigger input. Because it is overdriven, the duty-cycle is limited to 5%. The maximum pulse width is limited to 1- μ s. A governor circuit in the system prevents the system from exceeding 5% duty cycle, which could damage the LED. The light distribution from the unit is approximately Gaussian for distances greater than 18-inches [45-cm] from the source. The units are available in 400-nm and 460-nm packages, however, other wavelenths are available upon request.



Ordering information: LM2X-DMHP-XXX (LED head with short-pulse/high-power driver –XXX denotes wavelength)

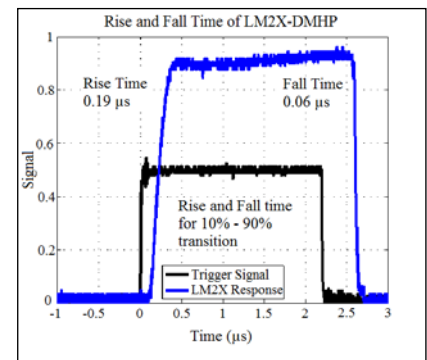
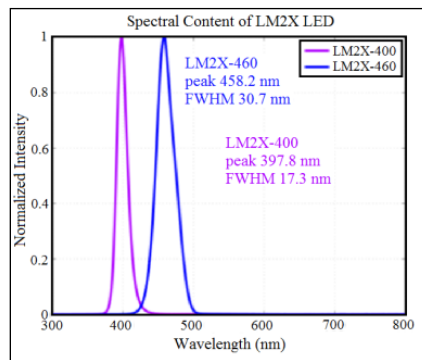
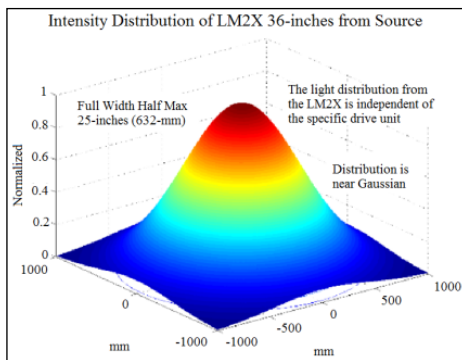

SPECIFICATIONS

Optical Power	1.1 W
Input	48V --- 2.7A
Stability	~0.1 % per hour after warmup
Wavelength	400-nm, 460-nm
Rise time (10% - 90%)	< 200 ns
Fall time (90% - 10%)	~ 100 ns
Maximum Duty Cycle	5%
Operating Temperature	-10°C to 60°C
FWHM	+/- 18-nm
ECCN	EAR99

Innovative Scientific Solutions, Inc.
7610 McEwen Road, Dayton, OH 45459
Phone (937) 630-3012 Fax (937) 630-3015

email: issi-sales@innssi.com
web: www.psp-tsp.com

Any and all underlying information and technology contained in this document may be subject to U.S. export controls, including the Export Administration Act (50 U.S.C. Appx. §§ 2401 et seq.) and the Export Administration Regulations ("EAR", 50 C.F.R. Parts 730-774), and may be subject to export or import regulations in other countries. You are responsible for complying with all trade regulations and laws both foreign and domestic. Except as authorized by law or distributor agreement with ISSI, you agree and warrant not to export or re-export the information to any country, or to any person, entity, or end-user subject to U.S. export controls, including without limitation persons or entities listed on the U.S. Department of Commerce Bureau of Export Administration's Denied Parties List and the U.S. Department of Treasury's Specially Designated Nationals. You further represent and warrant that no U.S. federal agency has suspended, revoked, or denied your export privileges.

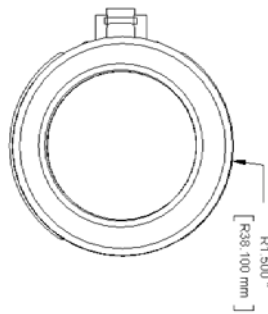
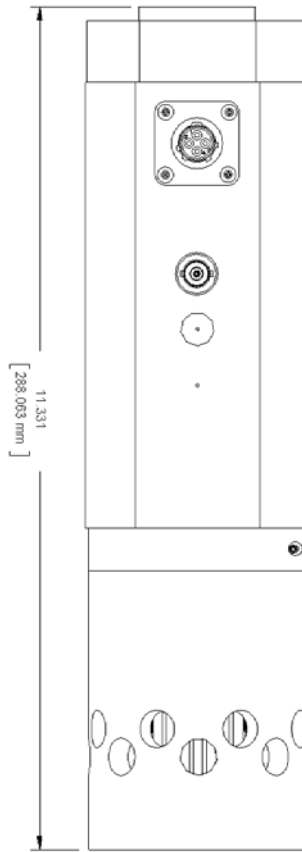

LM2X-DMHP-XXX

Innovative Scientific Solutions, Inc.
 7610 McEwen Road, Dayton, OH 45459
 Phone (937) 630-3012 Fax (937) 630-3015

email: issi-sales@innssi.com
 web: www.psp-tsp.com

Any and all underlying information and technology contained in this document may be subject to U.S. export controls, including the Export Administration Act (50 U.S.C. Appx. §§ 2401 et seq.) and the Export Administration Regulations ("EAR", 50 C.F.R. Parts 730-774), and may be subject to export or import regulations in other countries. You are responsible for complying with all trade regulations and laws both foreign and domestic. Except as authorized by law or distributor agreement with ISSI, you agree and warrant not to export or re-export the information to any country, or to any person, entity, or end-user subject to U.S. export controls, including without limitation persons or entities listed on the U.S. Department of Commerce Bureau of Export Administration's Denied Parties List and the U.S. Department of Treasury's Specially Designated Nationals. You further represent and warrant that no U.S. federal agency has suspended, revoked, or denied your export privileges.